

**Lyrenacarriga Wind Farm,
Co. Cork & Co. Waterford
Planning Permission Application Drawings
Further Information Response (ABP 309121-21)**





Schedule of Drawings – FI

Drawing No.	Drawing Title	Scale
170749e – 01 FI	Site Layout Plan (T5 Proposed Relocation) Sheet 2 of 4	1: 5,000 @ A1
170749e – 02 FI	Site Layout Plan (T5 Proposed Relocation) Sheet 3 of 4	1: 5,000 @ A1
170749e – 03 FI	Site Layout Plan (T5 Proposed Relocation) Sheet 4 of 11	1: 2,500 @ A1
170749e – 04 FI	Met Mast Compound Elevation	1: 250 @ A3
170749e – 05 FI	Wind Turbine Range Elevations & Plan	1: 500 @ A1
170749e – 06 FI	Wind Turbine Range Elevations & Plan	1: 500 @ A1

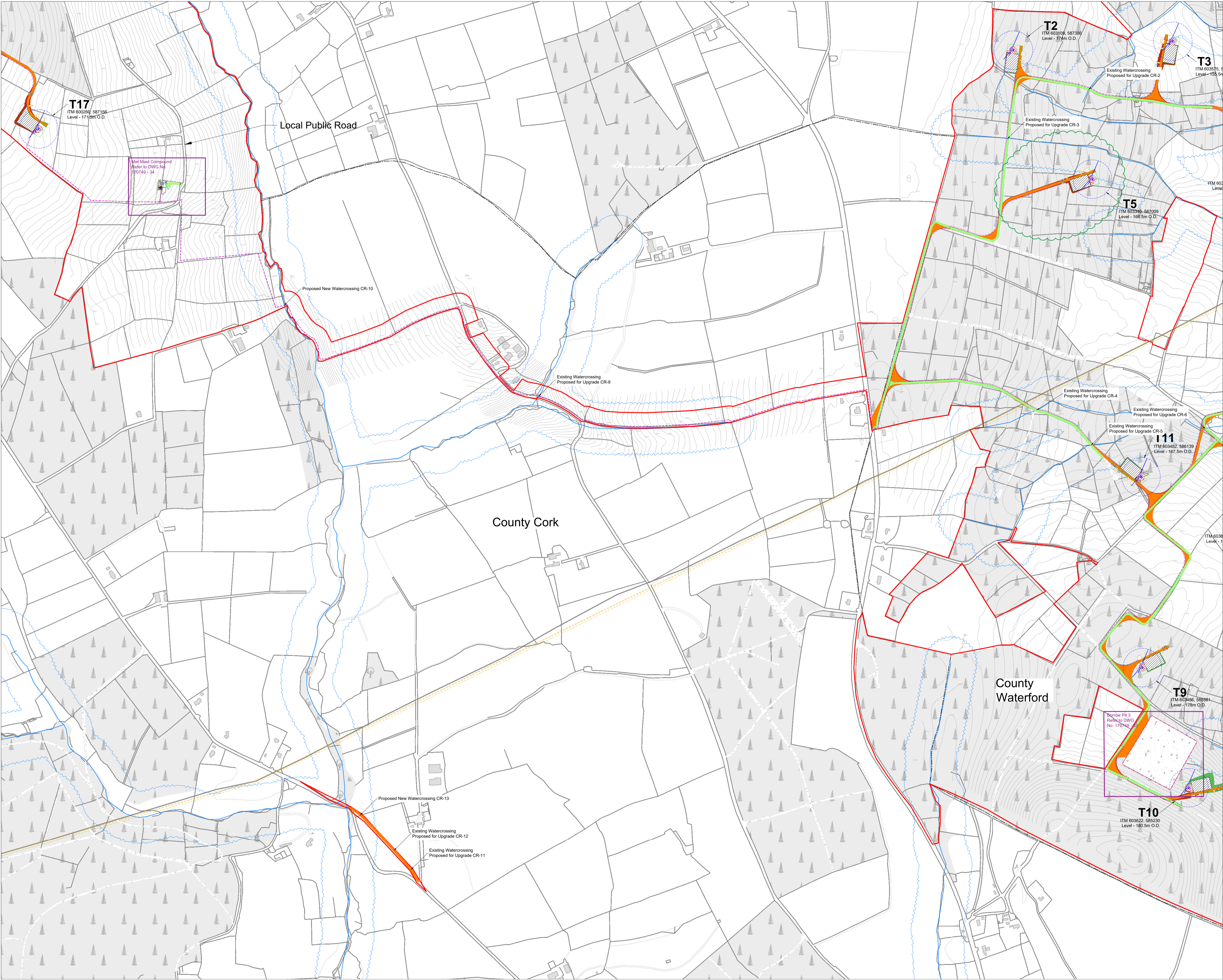

- Project Design Drawing Notes**
1. Drawings issued are for planning application purposes only.
 2. Drawings not to be used for construction/contract conditions.
 3. Copyright, all rights reserved. No part hereof may be copied or reproduced partially or wholly in any form whatsoever without the prior notice of the copyright owner McCarthy Keville O'Sullivan.
 4. Do not scale off this drawing. Figured metric dimensions only should be taken off this drawing.
 5. All contractors, whether main or sub-contractors, must visit the site and are responsible for taking and checking any and all dimensions and levels that relate to the works.
 6. The use of or reliance upon this drawing shall be deemed to be acceptance of these conditions of use unless otherwise agreed in writing, such written agreement to be sought from and issued by the copyright holder to the user or reliance upon this drawing.
 7. Layout plans show typical Turbine rotor diameter as per turbine drawing.
 8. Final levels may vary depending on local ground conditions.
- Drainage Design Notes**
1. All drainage subject to micro-siting and optimisation on site.
 2. The locations of the interceptor drains, check dams, culverts, swales, stilling ponds and level spreaders are shown as indicative, and may be changed to suit the requirements of the local topography.
 3. Supervising hydrologist or environmental clerk of works (environmental scientist) to oversee installation of drainage features following detailed drainage design.
 4. Drainage measures to be installed prior to, or at the same time as the works areas they are intended to drain.
 5. Design elevation of the water surface along the route of the interceptor drains or swales will not be lower than the design elevation of the water surface in the outlet at the level spreader or stilling pond.
 6. The spacing and frequency of the check dams will be dependant on the gradient of the interceptor drain or swale in which they are being installed.
 7. Check dam designs to be selected best to suit particular topography and hydrological environment.
 8. Down gradient slope below level spreader onto which the water will dissipate to have a grade less the 6%.
 9. No direct discharge or pumping to watercourses will be permitted. All discharges from level spreaders or stilling ponds to be via vegetated filters. Selection or suitable areas to use as vegetation filters will be determined by the size of the contributing catchment, slope and ground conditions.
 10. Stilling ponds to be sized according to the area they will be receiving water from.
 11. Diversion of drainage ditches will only take place when alternative drainage ditch has been installed to handle the same water.
 12. Existing drains/ditches to be incorporated or removed during wind farm construction.
 13. All drainage system features to be subject of inspection and maintenance plan.
 14. The layout shown is slightly offset for scale purposes, and all drainage would be installed as close to the road as possible.

- Drawing Legend**
- Planning Application Boundary
 - Existing Road to be Upgraded
 - Proposed Road
 - Electrical Cable Trench
 - River/Stream
 - 75m River/Stream Buffer
 - Works Area
 - Soft Levelled Area
 - Crane Pad Hardstanding Area
 - Turbine Foundation
 - Turbine Sweep Area
 - Borrow Pit
 - Cut
 - Fill
 - Existing 110kV Overhead Line
 - County Border

N

Ordnance Survey Ireland Licence No. CYAL50287517© Ordnance Survey Ireland/Government of Ireland

DRAWING TITLE:
**Site Layout Plan
 (T5 Proposed Relocation)
 Sheet 2 of 4**

PROJECT TITLE:
**Lyrenacarriga Wind Farm,
 Co. Cork & Co. Waterford - FI Response**

DRAWING BY: Joseph O'Brien	CHECKED BY: Meabhann Crowe
PROJECT No.: 170749e	DRAWING No.: 170749e - 01 FI
SCALE: 1:5,000 @ A1	DATE: 30.09.2022

OS SHEET No.: 6108, 6109, 6110, 6111, 6112, 6154, 6155, 6156, 6157, 6158, 6201, 6202, 6203, 6204, 6205, 6249, 6250, 6251, 6252, 6253

MKO
 Planning and
 Environmental
 Consultants
 Tuam Road, Galway
 Ireland, H91 VM84
 +353 (0) 91 735611
 email: info@www.mkofireland.ie
 Website: www.mkofireland.ie

Project Design Drawing Notes

1. Drawings issued are for planning application purposes only.
2. Drawings not to be used for construction/contract conditions.
3. Copyright, all rights reserved. No part hereof may be copied or reproduced partially or wholly in any form whatsoever without the prior notice of the copyright owner McCarthy Keville O'Sullivan.
4. Do not scale off this drawing. Figured metric dimensions only should be taken off this drawing.
5. All contractors, whether main or sub-contractors, must visit the site and are responsible for taking and checking any and all dimensions and levels that relate to the works.
6. The use of or reliance upon this drawing shall be deemed to be acceptance of these conditions of use unless otherwise agreed in writing, such written agreement to be sought from and issued by the copyright holder to the use or reliance upon this drawing.
7. Layout plans show typical Turbine rotor diameter as per turbine drawing.
8. Final levels may vary depending on local ground conditions.

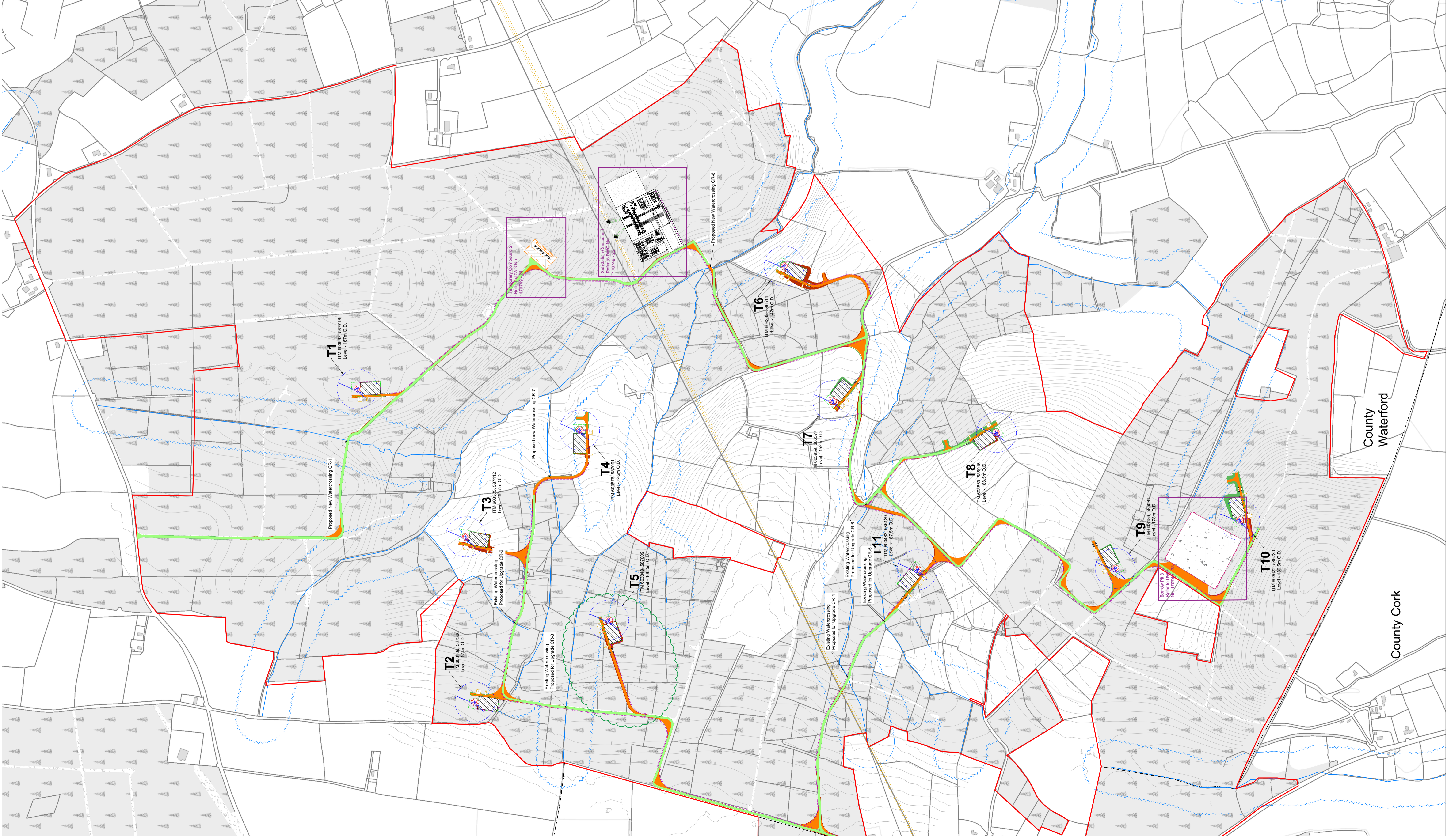

Drawing Legend

- Planning Application Boundary
- Existing Road to be Upgraded
- Proposed Road
- Electrical Cable Trench
- River/Stream
- 75m River/Stream Buffer
- Works Area
- Soft Levelled Area
- Crane Pad Hardstanding Area
- Turbine Foundation
- Turbine Sweep Area
- Borrow Pit
- Cut
- Fill
- Existing 110kV Overhead Line
- County Border

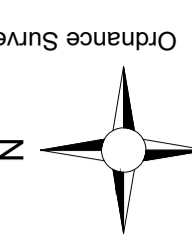

DRAWING TITLE
Site Layout Plan
(T5 Proposed Relocation)
Sheet 3 of 4

PROJECT TITLE
Lyrencarriga Wind Farm,
Co. Cork & Co. Waterford - F1 Response

DRAWING BY
Joseph O'Brien

CHECKED BY
Meabhann Crowe

DRAWING NO.
170749e

PROJECT NO.
170749e - 02 F1

SCALE:
1:5,000 @ A1

DATE:
30.09.2022

OS SHEET NO.:
4458 4459 4460 4461 4462 4463 4464 4465 4466 4467 4468
4021 4022 4023 4024 4025 4026 4027 4028 4029 4030



MKO
Planning and
Environmental
Consultants
Team Road, Galway
Ireland H91 V9B4
+353 (0) 91 735611
email: info@www.mkoireland.ie
Website: www.mkoireland.ie

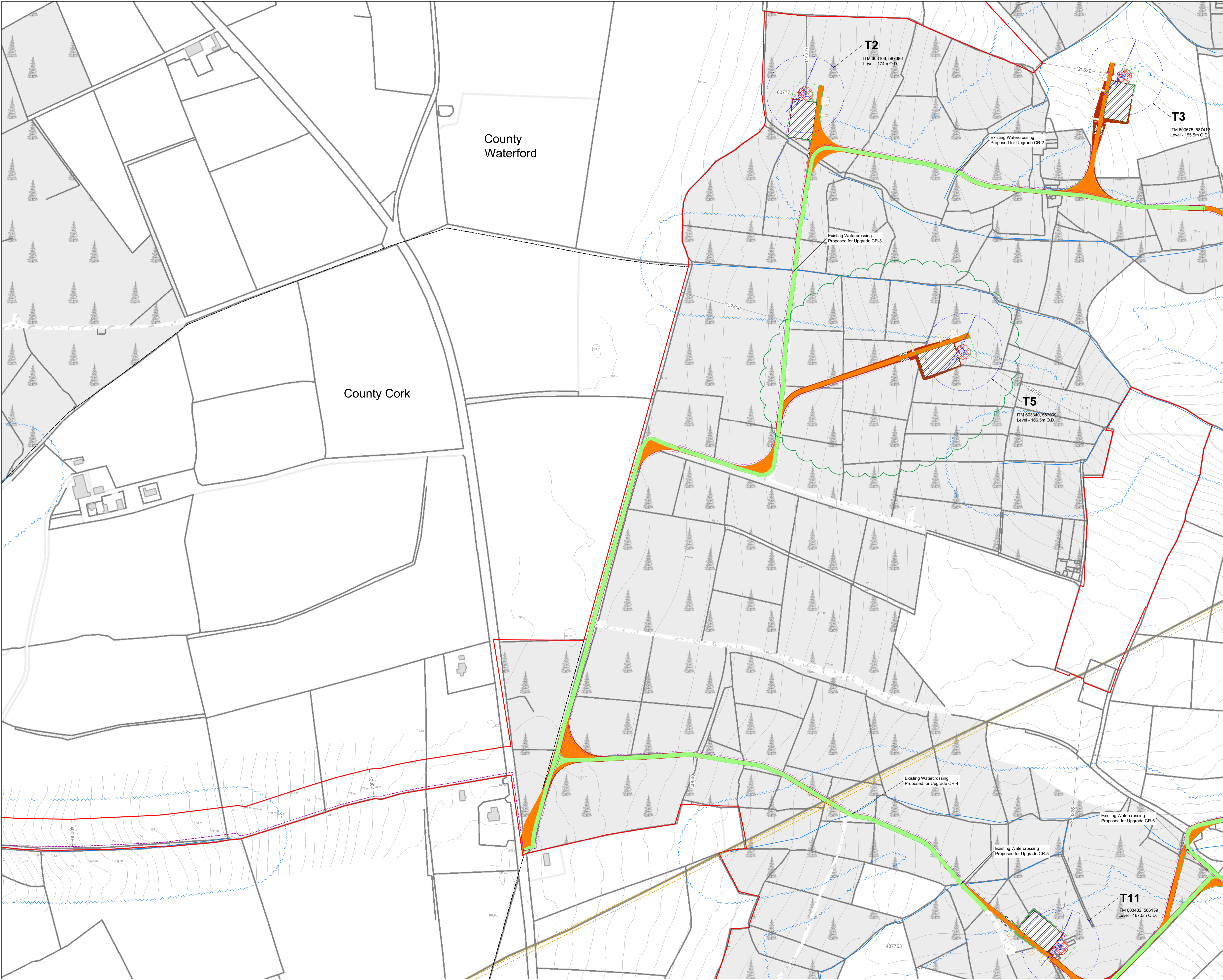

- Project Design Drawing Notes**
1. Drawings issued are for planning application purposes only.
 2. Drawings not to be used for construction/contract conditions.
 3. Copyright, all rights reserved. No part herewith may be copied or reproduced partially or wholly in any form whatsoever without the prior notice of the copyright owner McCarthy Keville O'Sullivan.
 4. Do not scale off this drawing. Figured metric dimensions only should be taken off this drawing.
 5. All contractors, whether main or sub-contractors, must visit the site and are responsible for taking and checking any and all dimensions and levels that relate to the works.
 6. The use of or reliance upon this drawing shall be deemed to be acceptance of these conditions of use unless otherwise agreed in writing, such written agreement to be sought from and issued by the copyright holder to the use or reliance upon this drawing.
 7. Layout plans show typical Turbine rotor diameter as per turbine drawing.
 8. Final levels may vary depending on local ground conditions.

- Drawing Legend**
- Planning Application Boundary
 - Existing Road to be Upgraded
 - Proposed Road
 - Electrical Cable Trench
 - River/Stream
 - 75m River/Stream Buffer
 - Works Area
 - Soft Levelled Area
 - Crane Pad Hardstanding Area
 - Turbine Foundation
 - Turbine Sweep Area
 - Cut
 - Fill
 - County Border
 - Existing 110kV Overhead Line

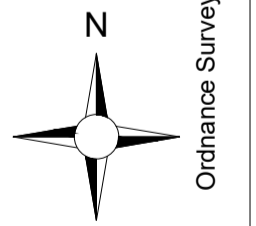

DRAWING TITLE: Site Layout Plan (T5 Proposed Relocation)
Sheet 4 of 11

PROJECT TITLE: Lyrenacarriga Wind Farm, Co. Cork & Co. Waterford - FI Response

DRAWING BY: Joseph O'Brien **CHECKED BY:** Meabhann Crowe

PROJECT No.: 170749e **DRAWING No.:** 170749e - 03 FI

SCALE: 1:2,500 @ A1 **DATE:** 30.09.2022

OS SHEET No.: 6108, 6109, 6110, 6111, 6112, 6154, 6155, 6156, 6157, 6158, 6201, 6202, 6203, 6204, 6205, 6249, 6250, 6251, 6252, 6253

MKO
 Planning and Environmental Consultants
 Tuam Road, Galway
 Ireland, H91 VM84
 +353 (0)91 735611
 email: info@www.mkofireland.ie
 Website: www.mkofireland.ie

Ordnance Survey Ireland Licence No. CYAL50267517© Ordnance Survey Ireland/Government of Ireland

Drawing Notes

- 1. Met mast on site will be free standing met mast.



DRAWING TITLE:	Met Mast Compound Elevation
PROJECT TITLE:	Lyrenacarriga Wind Farm, Co. Cork & Co. Waterford - FI Response
DRAWING BY:	GD
CHECKED BY:	DT
PROJECT No:	1707496
DRAWING No:	1707496 - 04 FI
SCALE:	1:250 @ A3
DATE:	30.09.2022



Drawing Notes

1. Proposed wind turbines to have a maximum ground to blade tip height of 150m.
2. Exact make and model of the turbine to be dictated by a competitive tender process.
3. Installed wind turbine will fall within the parameters set out above in any blade length and hub-height configuration
4. Turbine foundation diameter may range from 18m to 20m and have a depth ranging from 3.2m to 3.8m. The final foundation design would be within these design parameters but will depend on the turbine type and will be calculated by structural engineers at detailed design stage.
5. Ground level represents the top of turbine foundation.

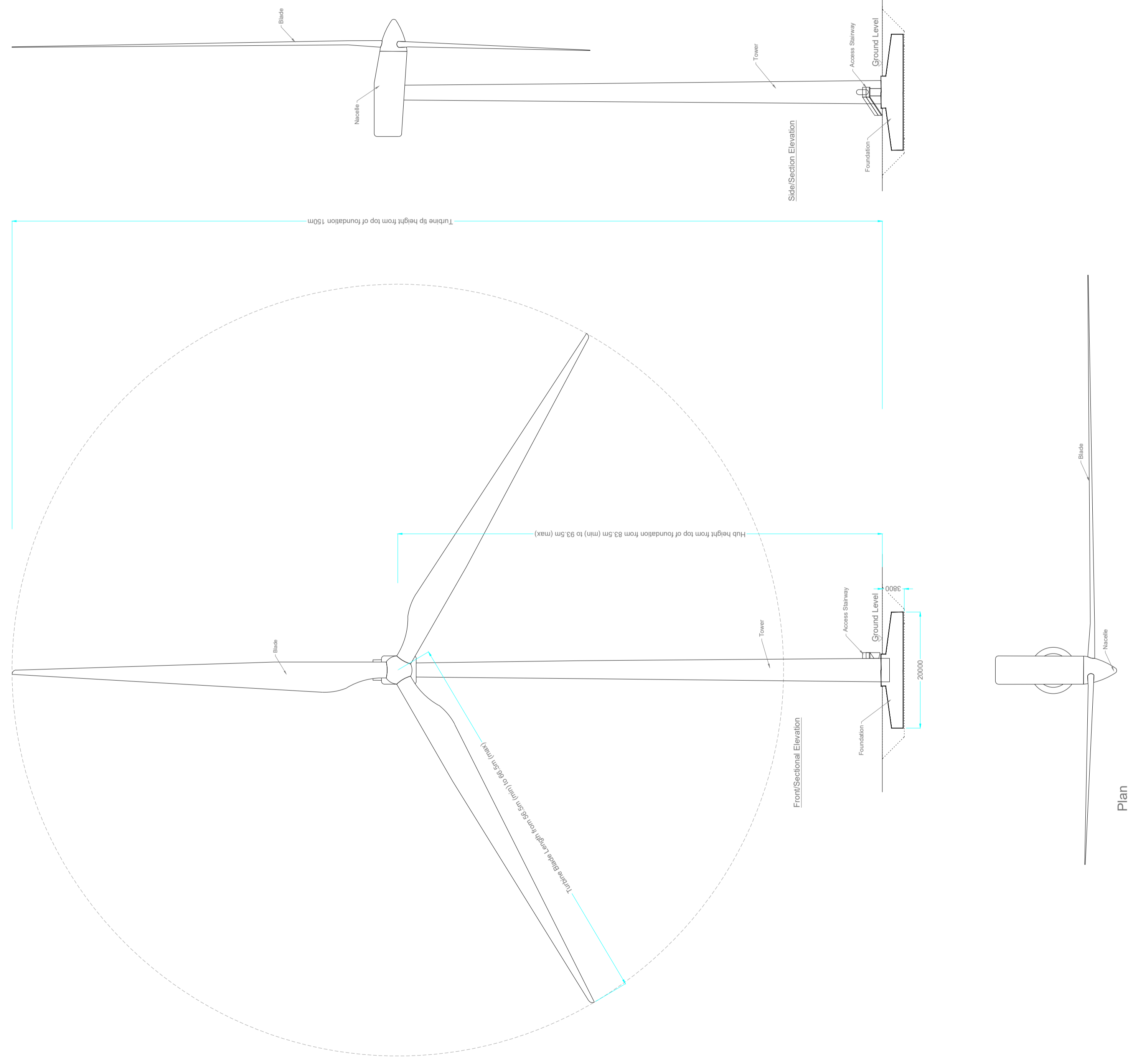

DRAWING TITLE

Wind Turbine Range Elevations & Plan

PROJECT TITLE

Lyrenacarriga Wind Farm,
Co. Cork & Co. Waterford – FI Response

CHECKED BY

Joseph O Brien

DRAWING NO.

170749e

PROJECT NO.

170749e - 05 FI

SCALE

1:500 @ A1

DATE

30.09.2022



MKO
Tumm Road, Galway
Ireland, H91 VW84
+353 (0) 91 759511
email: info@www.mkoireland.ie
Website: www.mkoireland.ie

98.5m hub and 96.5m blade	
83.5m hub and 66.5m blade	
91.5m hub and 86.5m blade	

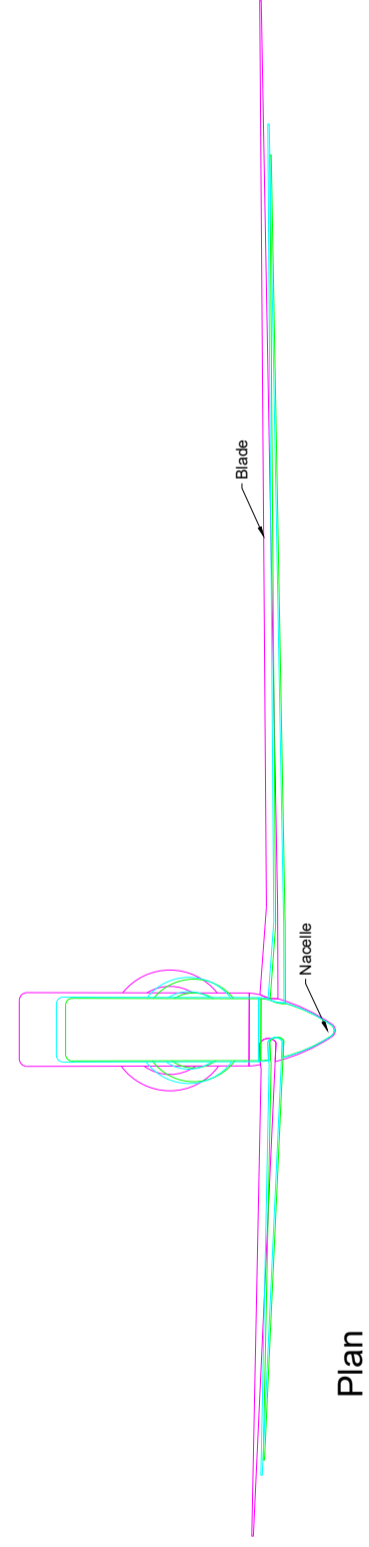
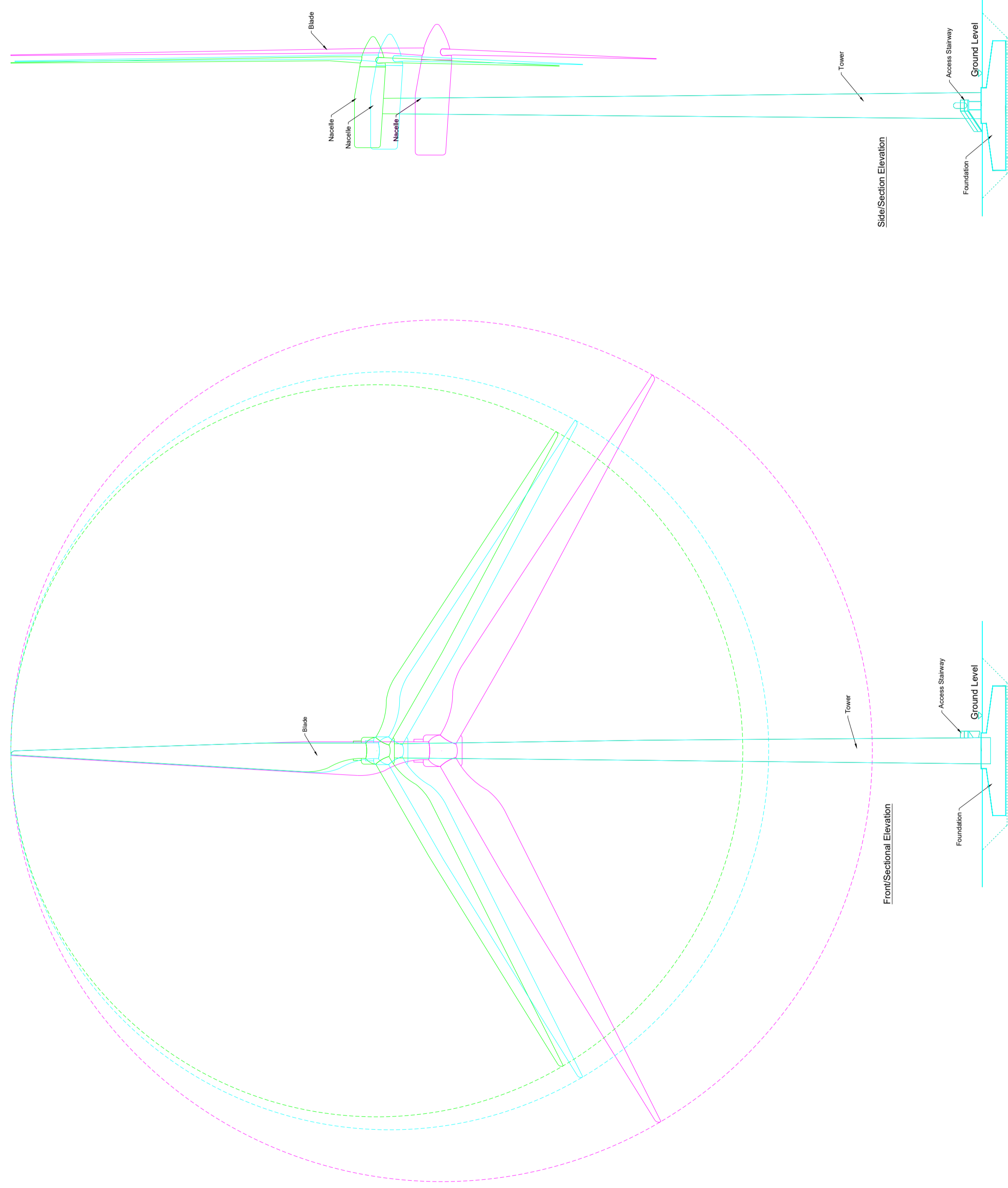

Drawing Notes

- Proposed wind turbines to have a maximum ground to blade tip height of 150m.
- Exact make and model of the turbine to be dictated by a competitive tender process.
- Installed wind turbine will fall within the parameters set out above in any blade length and hub-height configuration
- Turbine foundation diameter may range from 18m to 20m and have a depth ranging from 3.2m to 3.8m. The final foundation design would be within these design parameters but will depend on the turbine type and will be calculated by structural engineers at detailed design stage.
- Ground level represents the top of turbine foundation.

DRAWING TITLE

Wind Turbine Range Elevations & Plan

PROJECT TITLE

Lyrenacarriga Wind Farm,
Co. Cork & Co. Waterford – FI Response

CHECKED BY

Joseph O'Brien

DRAWING NO.

170749e

PROJECT NO.

170749e - 06 FI

SCALE

1:500 @A1

DATE

30.09.2022



MKO
Tumm Road, Galway
Ireland, H91 VW84
+353 (0) 91 735611
email: info@www.mkoireland.ie
Website: www.mkoireland.ie